

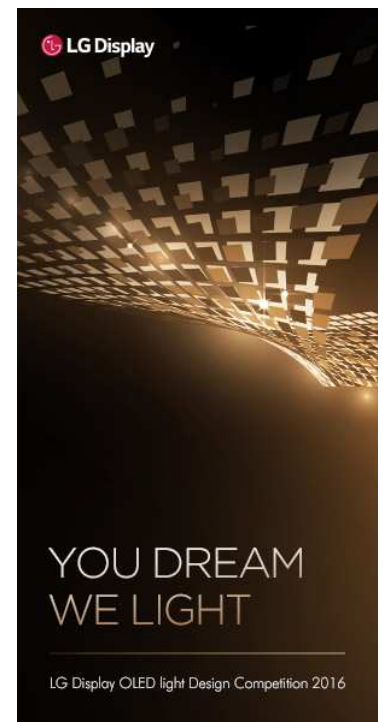

dominique coulton blends care & retirement home into the landscape of northern france



dominique coulton has completed a large healthcare facility for dependent elderly people in the northwestern french village of orbec. visible from the valley below, the 115-bed care and retirement home follows the topography of the hillside, and has been designed to be as unobtrusive as possible. to reduce the imposing structure's visual impact, the design team divided it into smaller volumes that fan out across the landscape.



publish your work



all images © [eugeni pons](#)

dominique couloun & associés sought to further disguise the mass through an effective use of color. 'we achieved the desired effect by using the colour green, with the result that the building both blends into the larger landscape and reflects the rural nature of the site,' explain the architects. 'the under-faces of the overhangs and the white walls of the base produce a feeling of lightness.'

product library



latest from blu dot



architecture in france

(76 articles)



dominique couloun
blends care &
retirement home
sep 07, 2016



the floating OFF
hotel docks by the
riverbank of the
jul 21, 2016



AAVP architecture
rests 69 housing
units atop a
jul 20, 2016



philippe starck's
wine cellar for
château les carmes
jul 13, 2016



coudamy
architectures wraps
parisian apartment
jun 28, 2016





to reduce the imposing structure's visual impact, the design team divided it into smaller volumes

each living unit fits into one section of the building, and all remain connected to a south-facing street, backed by the hill. this layout offers views through the structure from one side to the other, with light punctuating primary circulation routes. the color red has been used to 'destructure' the interiors, creating bold and dynamic spaces atypical to the conventional colors normally used in healthcare environments.



popular now architecture



OHLAB team realizes eco-house in mallorca, spain
sep 25, 2016



2001 revives house in bandoubashi, an abandoned property
sep 25, 2016



architecture
architecture adds monochromatic
sep 20, 2016



brandt + simon
architekten restores 1930's house in
sep 25, 2016



dRMM starts work on maggie's oldham, the world's
sep 25, 2016

dominique coulou & associates (5 articles)



dominique coulou blends care & retirement home
sep 07, 2016



dominique coulou stacks montpellier school as an
may 06, 2016

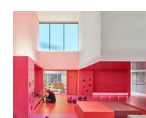

dominique coulou colors buhl nursery in pink and purple
mar 29, 2016



dominique coulou applies paint splatters to the
dec 26, 2015





the design team sought to further disguise the mass through the use of color



dominique coulton &
associés: josephine
baker school in la
may 02, 2011

Par exemple, pour un prêt personnel d'un montant de 8 000€ sur 36 mois, vous remboursez 36 mensualités de 232,16€ hors assurance facultative. Le Montant total dû est de 8 357,76€. Taux Annuel Effectif Global (TAEG) fixe de 2,90%. Taux débiteur fixe de 2,862%. Le coût mensuel de l'assurance facultative est de 10,35€ et s'ajoute aux mensualités ci-dessus. Le Taux Annuel Effectif de l'Assurance est de 3,016%. Le Montant total dû au titre de l'Assurance est de 372,60€.

En savoir plus

un crédit vous engage et doit être remboursé. vérifiez vos capacités de remboursement avant de vous engager.

 Sofinco
Gagnez en agilité





each living unit fits into one section of the building



the 115-bed care and retirement home follows the topography of the hillside



the color red has been used to 'destructure' the interiors



nws





interior spaces feature unconventional colors not normally used in healthcare environments



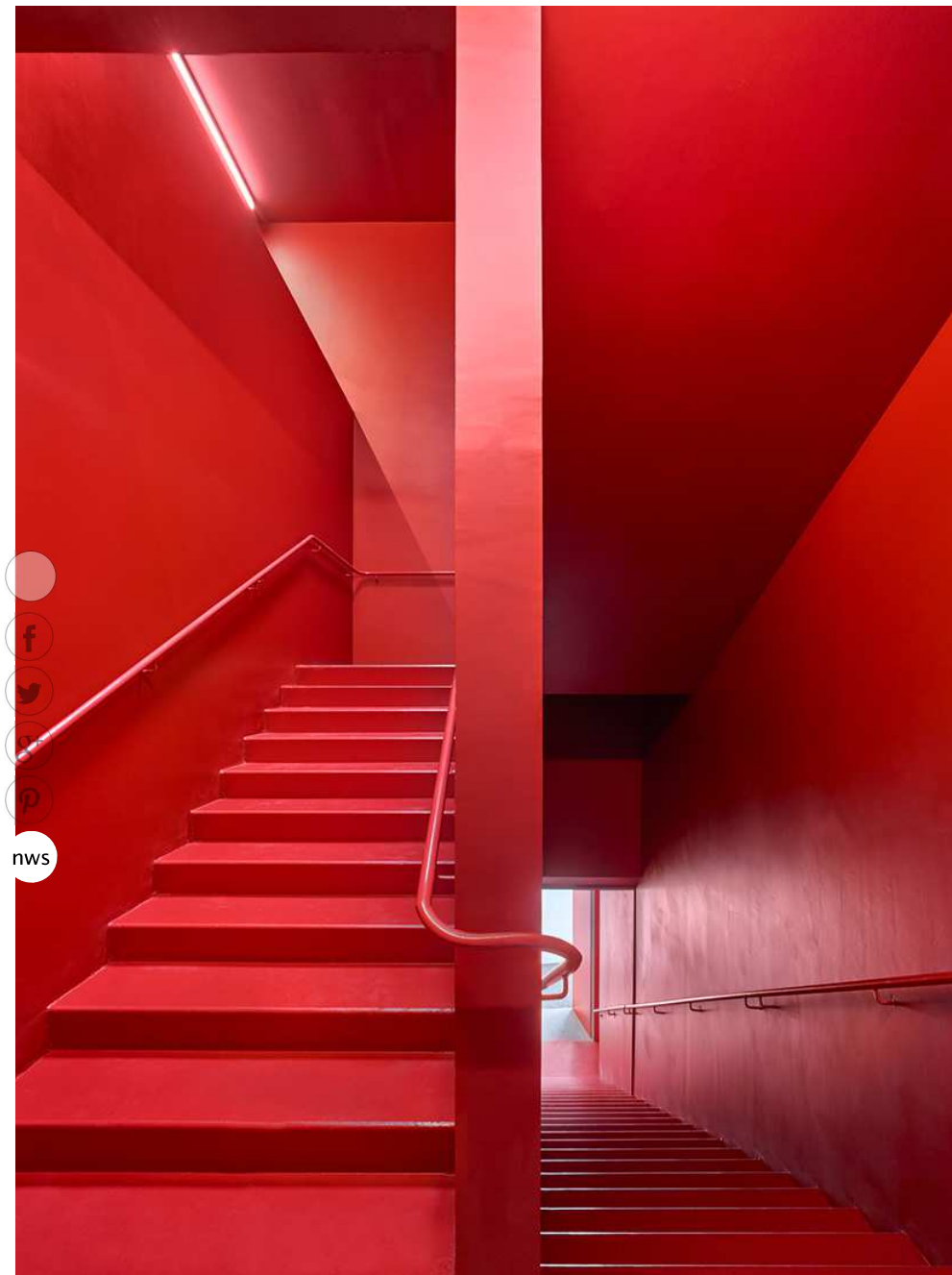

the use of bright colors extends to circulation routes





the layout offers views through the structure from one side to the other





all areas of the plan remain connected to a south-facing street





nws

the scheme is located in the northwestern french village of orbec





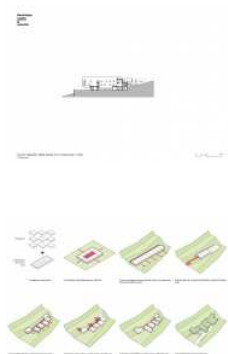

[full article here](#)

project info:

client: EPMS marie du merle in orbec

architect: dominique coulton & associés — dominique coulton, benjamin rocchi

architectural assistants: david romero-uzeda, olivier nicollas, chang zhang, javier gigosos ruipérez, pedro rodríguez ruipérez, ania klukowski, gautier duthoit

construction site supervision: emilie brichard, jean scherer

structural engineer: batiserf ingénierie

mechanical plumbing engineer: BET g.jost

electrical engineer: BET g.jost

cost estimator: E3 économie

acoustics: euro sound project

acoustic expert: ecotral

NWS,cape: bruno kubler

program: 115-room unit, combining a home for dependent elderly people and a nursing home: 85-bed home for dependent elderly people / 30-bed nursing home / day-center providing specially adapted activities and treatment / catering kitchen / administrative offices / treatment department

surface area: 5,833 sqm

budget: €12,279,536 € H.T

competition: september 2008

plans and technical phases: october 2008 – january 2012

construction: january 2012 – september 2015

photography: eugeni pons

philip stevens | designboom

sep 07, 2016



Have pity on the poor people who have been sentenced to spend their lives in this green red architectural prison.



bert staal

sep 08, 2016

name (required)

e-mail (will not be published) (required)

[comments policy](#)

LOG IN VIA



submit

designboom © 2016

[about us](#)

[advertise](#)

[contact us](#)

[copyright info](#)

[privacy](#)

[newsletter](#)

[cookies](#)

